

PLAN VIEW

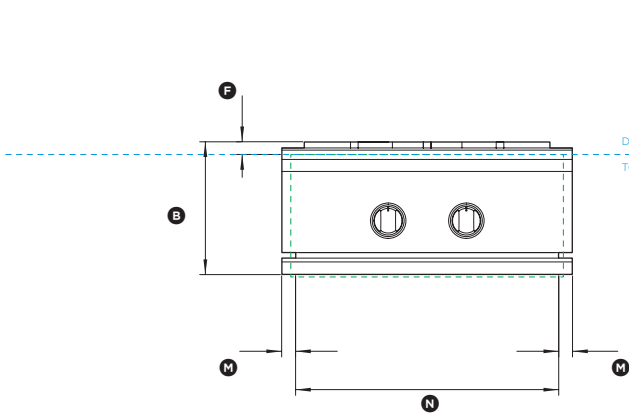

FRONT VIEW

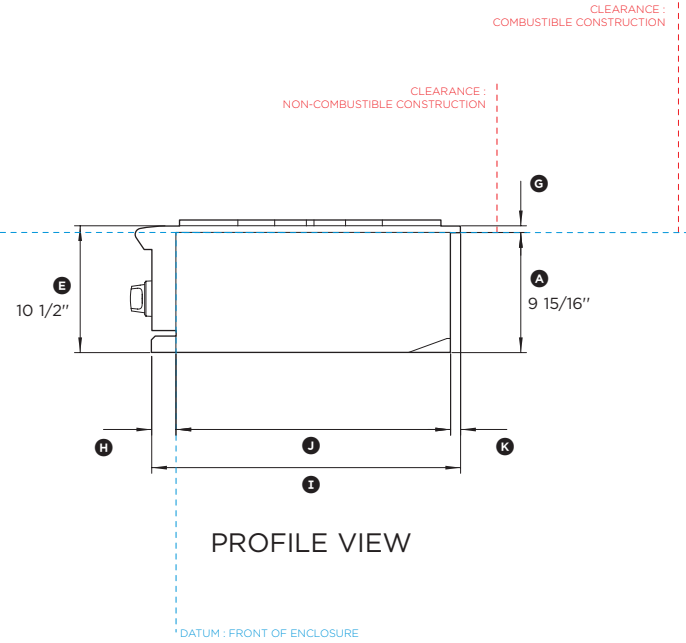
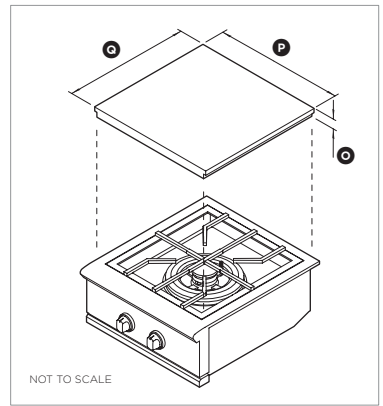

PROFILE VIEW

24" Power Burner

Model no:
PBE1 (refer page 2 for metric measurements)

Dimensions	in
A Height below countertop datum to bottom of chassis	9 15/16"
B Overall height of grill	11"
C Overall width of grill	24"
D Overall depth of grill (excluding knobs)	26 7/8"
E Height of chassis	10 1/2"
F Height above countertop	1 1/16"
G Height of chassis above countertop	9/16"
H Depth of control panel to front datum	2 1/16"
I Depth from control panel to rear of product	25 9/16"
J Depth from front datum to rear of chassis below countertop	22 1/2"
K Depth of rear flange	1"
L Depth from chassis bullnose to front datum	3 3/8"
M Width of side flanges	1 1/8"
N Width of chassis inside enclosure	21 3/4"
O Height of lid	1 11/16"
P Width of lid	23 5/8"
Q Depth of lid	23"

Minimum Clearances	in
Overall width of cavity	22 1/2"
Overall depth of cavity	22 3/4"
Overall height of cavity	10 1/8"
Clearance to vertical non-combustible surface above countertop at rear and sides	3"
Clearance to vertical combustible surface above countertop at rear and sides	18"

If the griddle is to be placed into a combustible enclosure, an approved insulated jacket is necessary. Use only the DCS insulated jacket which has specifically been designed and tested for this purpose.

24" insulated jacket part number: 71426

INDICATES CUTOUT
INDICATES PRODUCT / CABINETY DATUM
INDICATES CLEARANCES

DATE: **12.03.2020**

IMPORTANT NOTE: Throughout this guide, dimensions may vary by ±2mm (1/16"). Please read the installation manual for detailed information on installing the product. www.dcsappliances.com



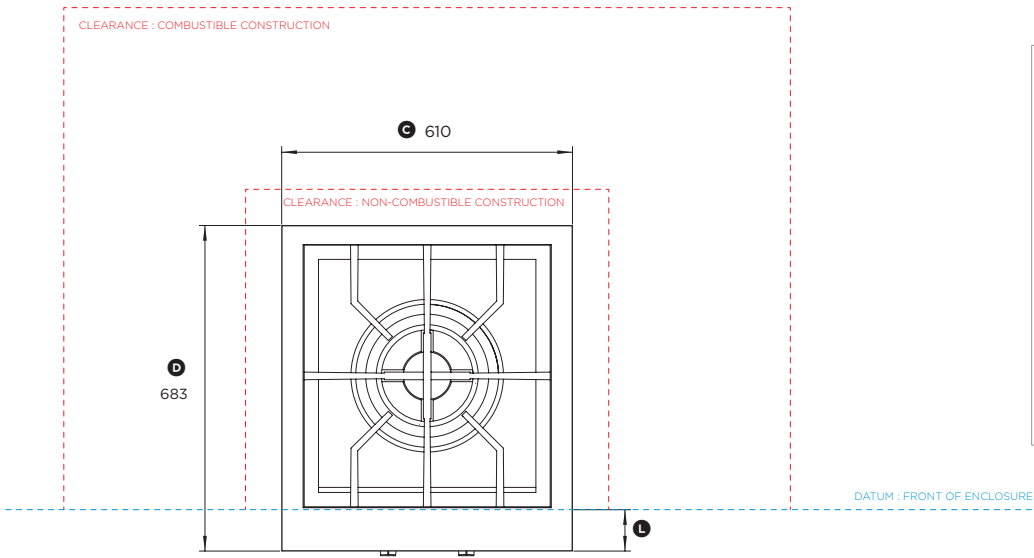

PLAN VIEW

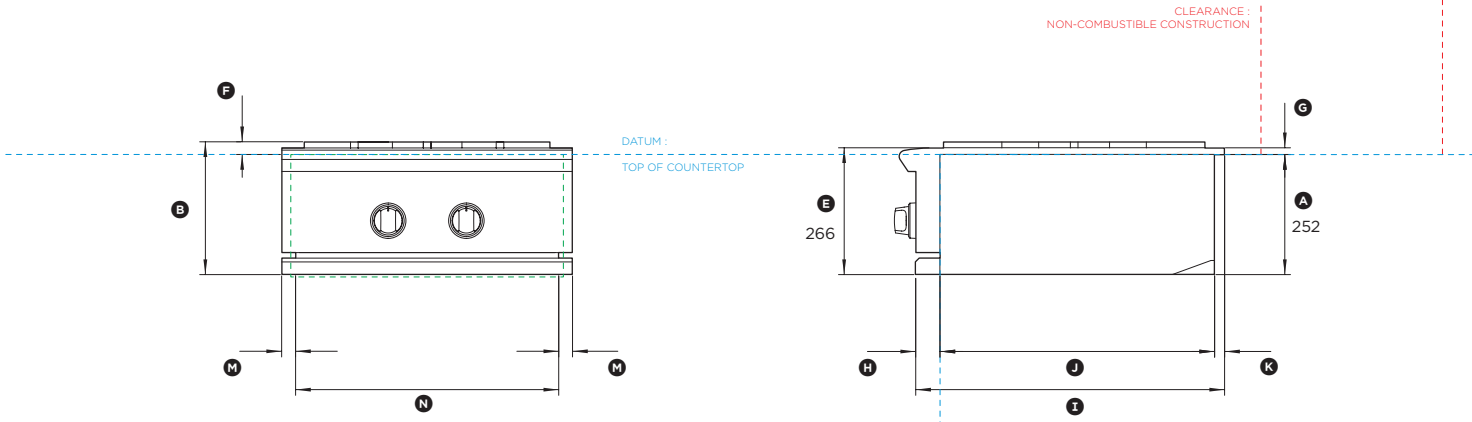

FRONT VIEW

PROFILE VIEW



24" Power Burner

Model no:
PBE1 (refer page 1 for imperial measurements)

Dimensions	mm
A Height below countertop datum to bottom of chassis	252
B Overall height of grill	279
C Overall width of grill	610
D Overall depth of grill (excluding knobs)	683
E Height of chassis	266
F Height above countertop	27
G Height of chassis above countertop	14
H Depth of control panel to front datum	52
I Depth from control panel to rear of product	649
J Depth from front datum to rear of chassis below countertop	572
K Depth of rear flange	25
L Depth from chassis bullnose to front datum	87
M Width of side flanges	29
N Width of chassis inside enclosure	552
O Height of lid	43
P Width of lid	600
Q Depth of lid	585

Minimum Clearances	mm
Overall width of cavity	572
Overall depth of cavity	578
Overall height of cavity	257
Clearance to vertical non-combustible surface above countertop at rear and sides	76
Clearance to vertical combustible surface above countertop at rear and sides	457

If the griddle is to be placed into a combustible enclosure, an approved insulated jacket is necessary. Use only the DCS insulated jacket which has specifically been designed and tested for this purpose.

24" insulated jacket part number: 71426

INDICATES CUTOUT
INDICATES PRODUCT / CABINETY DATUM
INDICATES CLEARANCES

DATE: 12.03.2020

IMPORTANT NOTE: Throughout this guide, dimensions may vary by $\pm 2\text{mm}$ (1/16"). Please read the installation manual for detailed information on installing the product. www.dcsappliances.com

